

Courses & Distances

N 89 E 68.

N 1 W 154.

S 88 W 74.

S 2 E 130.

S 10 E 23.

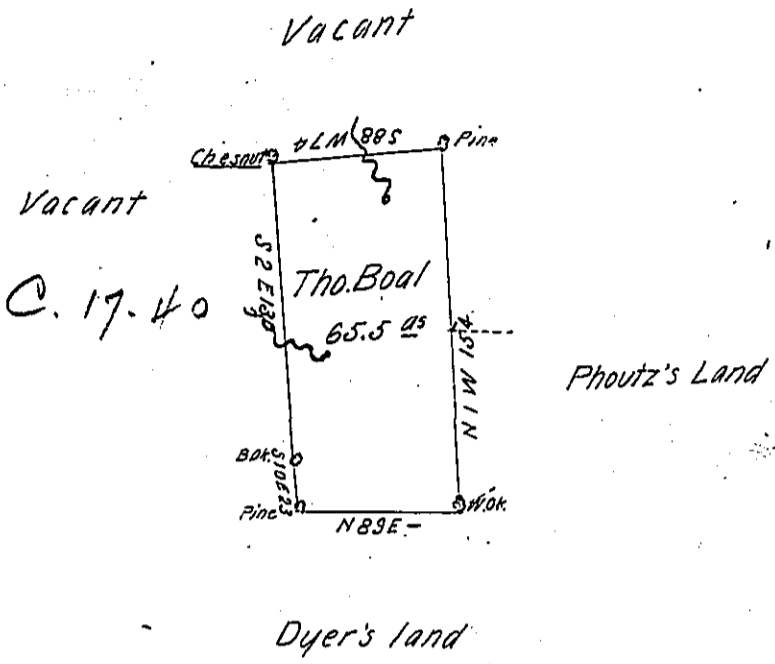

The Draught of a tract of land Situate in Greenwood Township Cumberland County Containing Sixty five acres & an half & the usual allowance of Six Per Cent for roads &c.^d Surveyed for Thomas Boal Dec^r the 22^d 1781 in pursuance of a Warrant from the Honorable the Proprietaries Dated May the 10th 1776

Ja^s Harris D.S.

John Lukens Esq^r Sur^v. Gen^l

IN TESTIMONY that the above is a copy of the original remaining on file in the Department of Internal Affairs of Pennsylvania, made conformably to an Act of Assembly approved the 16th day of February, 1833, I have hereunto set my Hand and caused the Seal of said Department to be affixed at Harrisburg, this fifth day of January 1904

James B. Brown
Secretary of Internal Affairs.

